

General Feature

- Absorbent Glass Mat(AGM) technology for efficient gas recombination of up to 99% and freedom from electrolyte maintenance or water adding.
- Not restricted for air transport-complies with IATA/ICAO Special Provision A67.
- UL-recognized component.
- Can be mounted in any orientation.
- Computer designed lead, calcium tin alloy grid for high power density.
- Long service life, float or cyclic applications.
- Maintenance-free operation.
- Low self discharge.

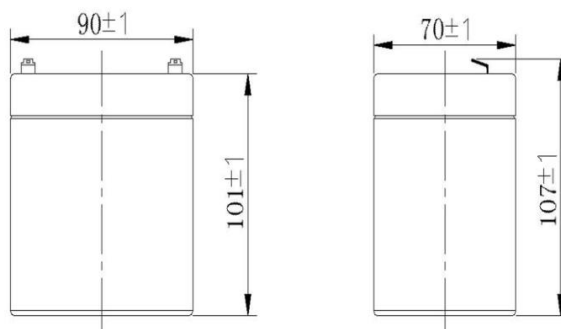

SPECIFICATION

| | |
|-----------------------------|-----------|
| Nominal voltage | 12V |
| Number of cell | 6 |
| Length(mm/inch) | 90/3.54 |
| Width(mm/inch) | 70/2.76 |
| Height(mm/inch) | 101/3.98 |
| Total Height(mm/inch) | 107/4.21 |
| Approx.Weight(kg/lbs) | 1.28/2.82 |

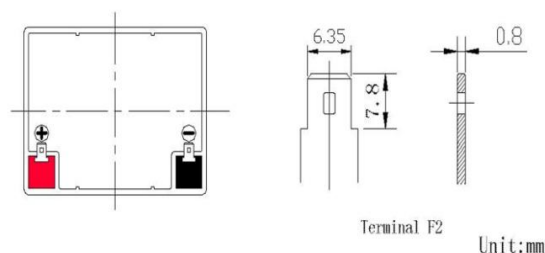

Battery Construction

| Component | Positive plate | Negative plate | Container | Cover | Safety valve | Terminal | Separator | Electrolyte |
|--------------|----------------|----------------|-----------|-------|--------------|----------|------------|---------------|
| Raw material | Lead dioxide | Lead | ABS | ABS | Rubber | Copper | Fiberglass | Sulfuric acid |

Performance Characteristics

| | | |
|-------------------------------------------------------|---------------------------------------------------|-------|
| Capacity 77°F(25°C) | 20 hours rate(0.2A 10.5V) | 4.0Ah |
| | 10 hours rate(0.38A 10.5V) | 3.8Ah |
| | 5 hours rate(0.7A 10.5V) | 3.5Ah |
| | 1 hour rate(2.5A 9.6V) | 2.5Ah |
| Internal Resistance | Full charged battery 77°F(25°C):35mΩ | |
| Capacity affected by Temperature (20 hour rate) | 104°F(40°C) | 102% |
| | 77°F(25°C) | 100% |
| | 32°F(10°C) | 85% |
| | 5°F(-15°C) | 65% |
| Self-Discharge 68°F(20°C) | Capacity after 3 month storage | 90% |
| | Capacity after 6 month storage | 80% |
| | Capacity after 12 month storage | 60% |
| Max discharge current 77°F(25°C):60A(5S) | | |
| Charge (Constant Voltage) | Float:13.6 to 13.8V/77°F/(25°C) | |
| | Cycle:14.5 to 14.9V/77°F/(25°C) Max Current:1A | |

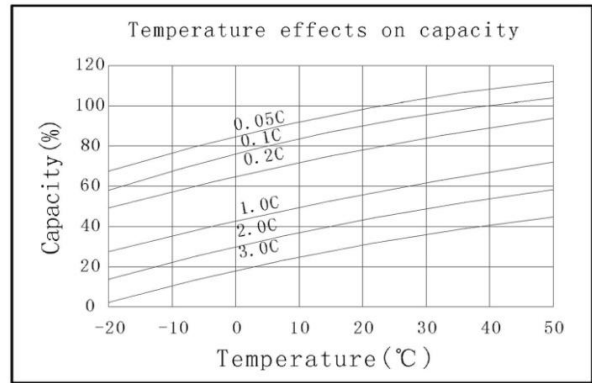
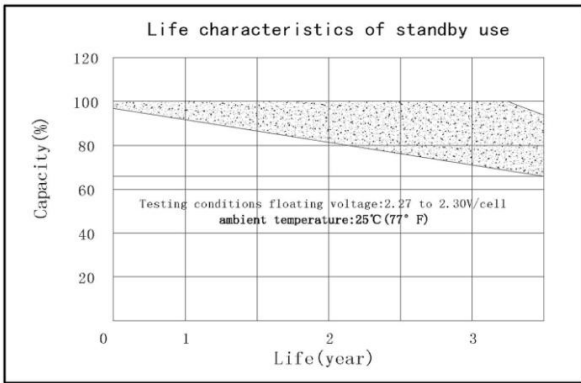
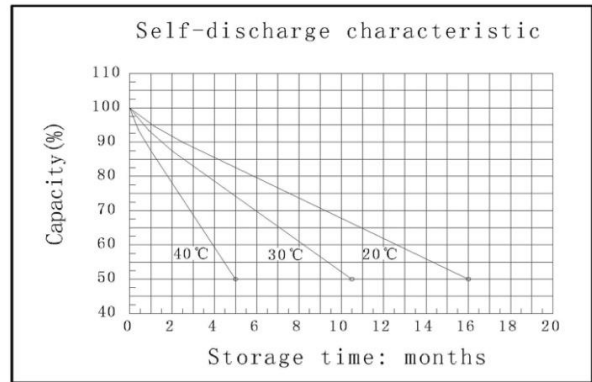
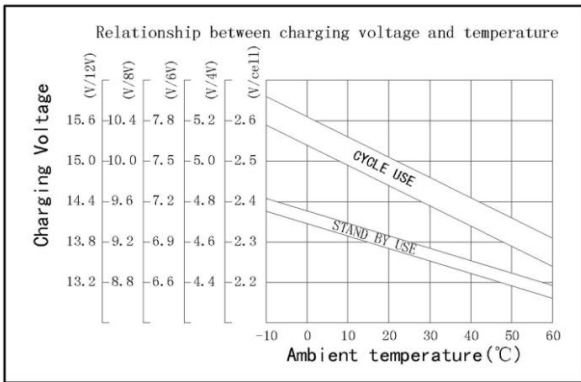
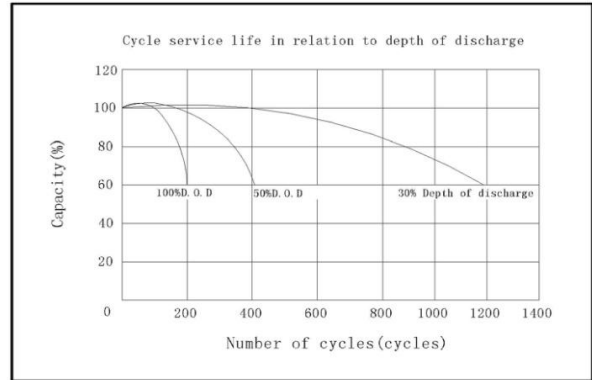
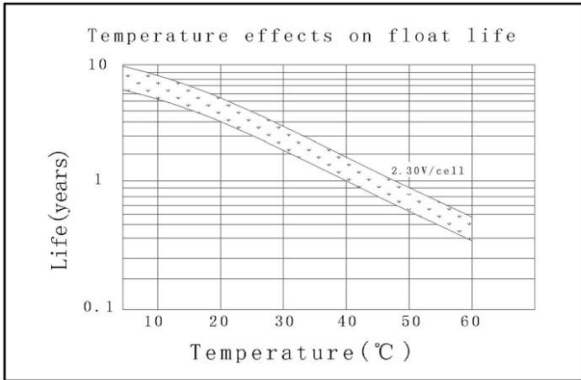
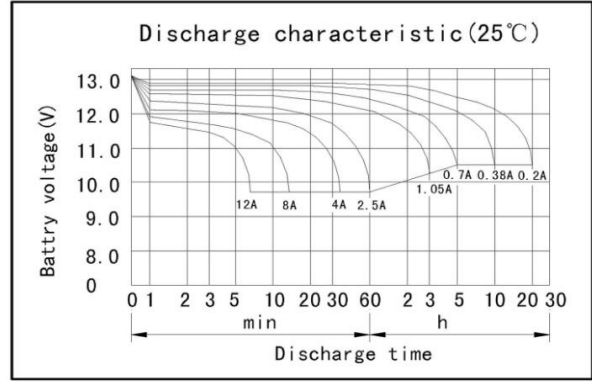
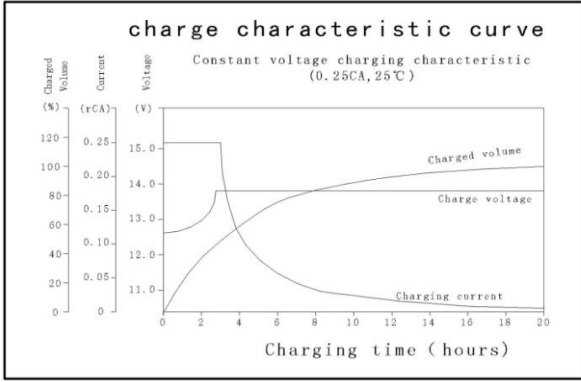

Discharge Constant Current (Amperes at 77°F 25°C)

| End Point Volts/Cell | 5min | 10min | 15min | 30min | 1h | 3h | 5h | 10h | 20h |
|----------------------|------|-------|-------|-------|------|------|------|------|------|
| 1.60V | 14.0 | 8.65 | 7.05 | 4.10 | 2.50 | 1.15 | 0.72 | 0.39 | 0.21 |
| 1.65V | 13.2 | 8.15 | 6.70 | 3.93 | 2.41 | 1.10 | 0.72 | 0.39 | 0.21 |
| 1.70V | 12.4 | 7.72 | 6.39 | 3.75 | 2.32 | 1.05 | 0.71 | 0.38 | 0.20 |
| 1.75V | 11.6 | 7.31 | 6.10 | 4.56 | 2.25 | 1.00 | 0.70 | 0.38 | 0.20 |
| 1.80V | 10.9 | 6.95 | 2.79 | 3.39 | 2.14 | 0.95 | 0.68 | 0.37 | 0.19 |

(Note) The above characteristics data are average values obtained Within three charge/discharge cycles not the minimum values.

Discharge Constant Power (watts at 77°F 25°C)

| End Point Volts/Cell | 5min | 10min | 15min | 30min | 45min | 1h | 2h | 3h | 5h |
|----------------------|------|-------|-------|-------|-------|------|------|------|------|
| 1.60V | 26.8 | 16.7 | 13.3 | 8.33 | 6.00 | 4.83 | 2.99 | 1.86 | 1.22 |
| 1.65V | 25.1 | 15.7 | 12.6 | 7.92 | 5.72 | 4.63 | 2.90 | 1.82 | 1.20 |
| 1.70V | 23.5 | 14.7 | 11.9 | 7.49 | 5.44 | 4.42 | 2.80 | 1.77 | 1.18 |
| 1.75V | 21.8 | 13.8 | 11.2 | 7.05 | 5.14 | 4.20 | 2.69 | 1.71 | 1.16 |
| 1.80V | 20.2 | 12.8 | 10.4 | 6.62 | 4.85 | 3.97 | 2.58 | 1.66 | 1.13 |

(Note) The above characteristics data are average values obtained Within three charge/discharge cycles not the minimum values.