

General Feature

- Absorbent Glass Mat(AGM) technology for efficient gas recombination of up to 99% and freedom from electrolyte maintenance or water adding.
- Not restricted for air transport-complies with IATA/ICAO Special Provision A67.
- UL-recognized component.
- Can be mounted in any orientation.
- Computer designed lead, calcium tin alloy grid for high power density.
- Long service life, float or cyclic applications.
- Maintenance-free operation.
- Low self discharge.

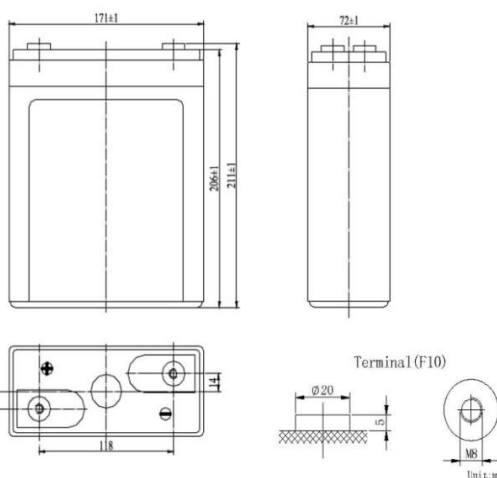

SPECIFICATION

Nominal voltage	2V
Number of cell	1
Length(mm/inch)	171/6.73
Width(mm/inch)	72/2.83
Height(mm/inch)	206/8.11
Total Height(mm/inch)	211/8.31
Approx.Weight(kg/lbs)	6.0/13.2

Battery Construction

Component	Positive plate	Negative plate	Container	Cover	Safety valve	Terminal	Separator	Electrolyte
Raw material	Lead dioxide	Lead	ABS	ABS	Rubber	Copper	Fiberglass	Sulfuric acid

Performance Characteristics

Capacity 77°F(25°C)	10 hours rate(10A 1.80V)	100Ah
	5 hours rate(17.6A 1.75V)	88Ah
	3 hours rate(25.8A 1.70V)	77.4Ah
	1 hour rate(65A 1.60V)	65Ah
Internal Resistance	Full charged battery 77°F(25°C):1mΩ	
Capacity affected by Temperature (10 hour rate)	104°F(40°C)	102%
	77°F(25°C)	100%
	32°F(10°C)	85%
	5°F(-15°C)	65%
Self-Discharge 68°F(20°C)	Capacity after 3 month storage	90%
	Capacity after 6 month storage	80%
	Capacity after 12 month storage	60%
Max discharge current77°F(25°C):500A(5S)		
Charge (Constant Voltage)	Float:2.25 to 2.30V/77°F/(25°C)	
	Cycle:2.35 to 2.45V/77°F/(25°C) Max Current:20A	

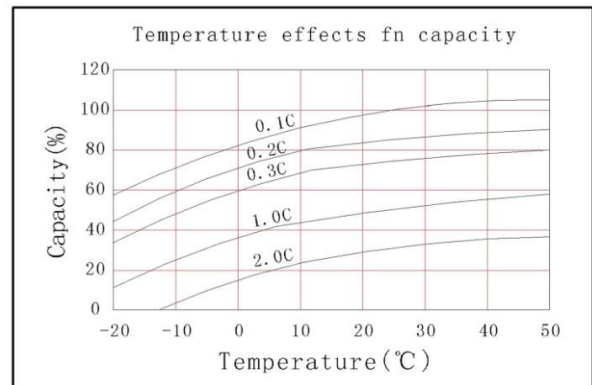
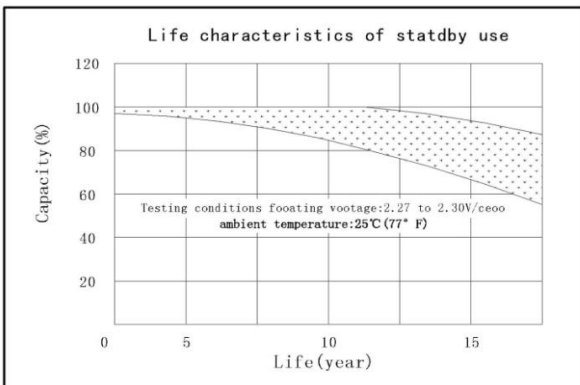
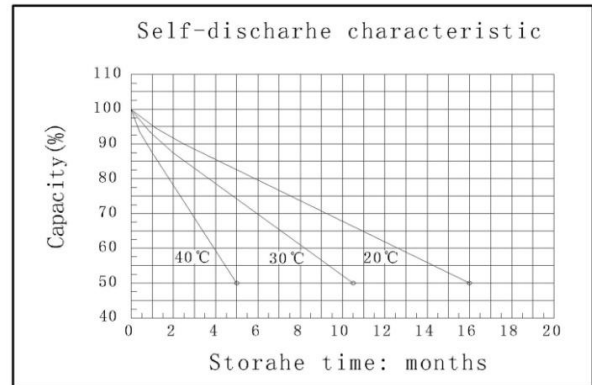
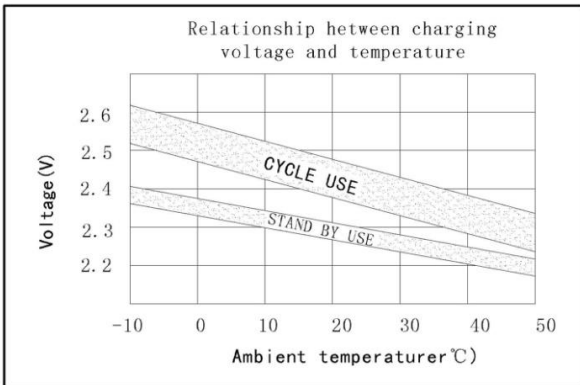
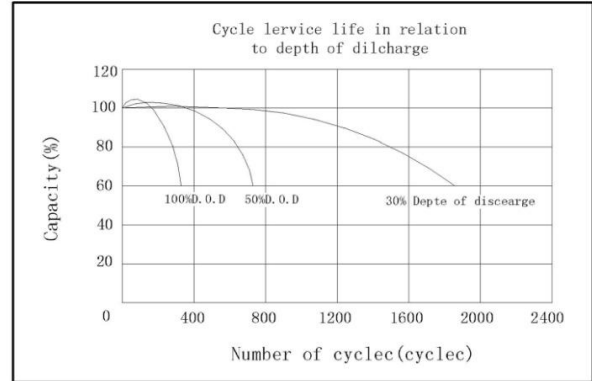
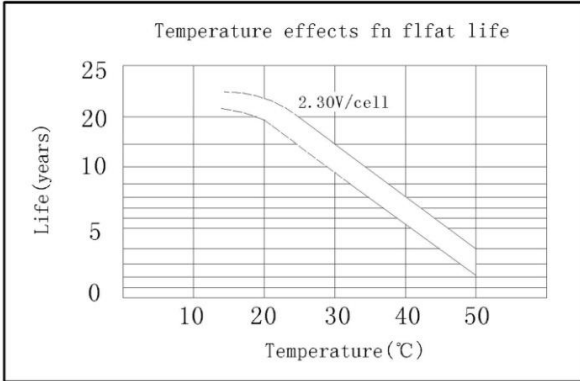
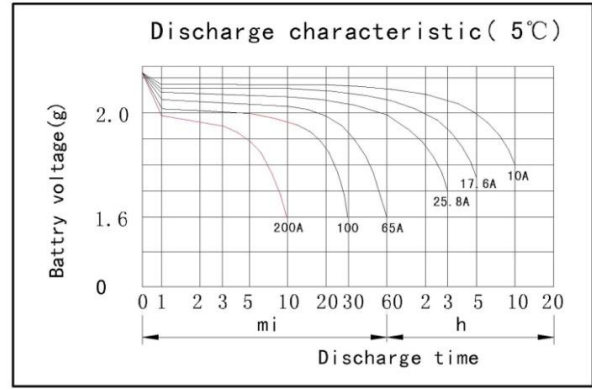
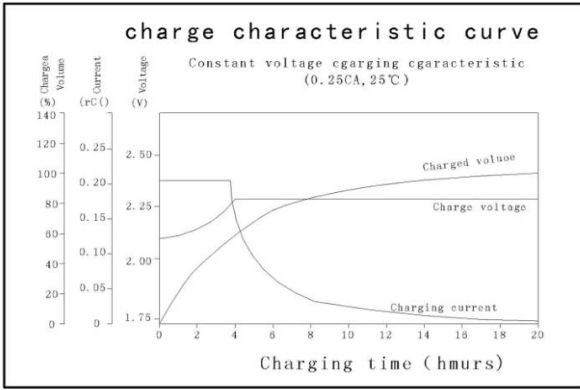

Discharge Constant Current (Amperes at 77°F 25°C)

End Point Volts/Cell	5min	10min	15min	30min	45min	1h	3h	5h	10h
1.60V		196	146	98.0	81.0	65.0	27.5	19.3	10.8
1.65V		186	140	94.0	78.0	62.5	26.5	18.8	10.6
1.70V		175	132	90.0	74.0	60.0	25.8	18.2	10.4
1.75V		164	125	85.0	71.0	57.0	24.7	17.6	10.2
1.80V		152	118	80.5	67.0	54.0	23.6	17.1	10.0

Discharge Constant Power (watts at 77°F 25°C)

End Point Volts/Cell	5min	10min	15min	30min	45min	1h	2h	3h	5h
1.60V		285	256	197	147	122	73.0	53.5	39.3
1.65V		269	242	187	140	117	71.0	52.2	38.6
1.70V		251	228	177	133	112	69.0	50.8	37.8
1.75V		233	213	165	126	105	66.0	49.2	37.0
1.80V		218	200	156	119	100	63.0	47.6	36.1

(Note) The above characteristics data are average values obtained within three charge/discharge cycles not the minimum values.

(Note) The above characteristics data are average values obtained within three charge/discharge cycles not the minimum values.